

## FERRULE FOR HOSE 1SN-R1AT - 2SC SKIVE

Code: **8001..**  
Type: **BP1**

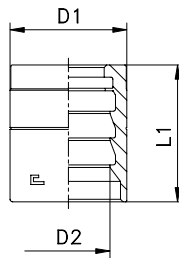

CODE	I.D. hose		Dimensions [mm]			Skiving lenght
	INCH	DN	D1	D2	L1	
800101	3/16	5	16	9,9	23,5	16
800102	1/4	6	19	12,7	25,5	18
800103	5/16	8	21	14	26,5	17,5
800104	3/8	10	23	16,3	27	18,5
800105	1/2	12	28	19,8	29	19,5
800106	5/8	16	31	23	32	22,5
800107	3/4	19	35	27,1	36	25
800108	1	25	42	34	44,5	32
800109	1 1/4	31	50	41,6	48	33,5
800110	1 1/2	38	56	47,9	55	39
800111	2	51	70	61,2	63	45,5

**Notes:** If you wish to order a fitting in stainless steel, please change the first two digit from **80....** to **81....** .

## FERRULE FOR HOSE 2SN-R2AT SKIVE

Code: **8002..**  
Type: **BP2**

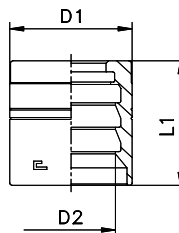

CODE	I.D. hose		Dimensions [mm]			Skiving lenght
	INCH	DN	D1	D2	L1	
800201	3/16	5	19	11,7	23,5	16
800202	1/4	6	20	13,7	25,5	18
800203	5/16	8	23	15,6	26,5	17,5
800204	3/8	10	24,5	17,8	27	18,5
800205	1/2	12	29	21,3	29	19,5
800206	5/8	16	33	24,3	32	22,5
800207	3/4	19	37	28,5	36	25
800208	1	25	45	35,8	44,5	32
800209	1 1/4	31	55	45,2	48	33,5
800210	1 1/2	38	61	51,5	55	39
800211	2	51	74	64,6	63	45,5

**Notes:** If you wish to order a fitting in stainless steel, please change the first two digit from **80....** to **81....** .